

STORAGETECH®

An ERGIL Group Brand



ATEX approved 

## BREATHER VALVE (Free Vent)

model number 150

### Product Description

Model Number 150 Free Vent is designed for use on tanks containing non-volatile liquids. Model Number 150 helps air and vapors to travel freely in and out of storage tanks, and also offers efficient flow capacity to protect storage tanks from positive or negative overpressure. Model Number 150 is designed to protect the vent against outside factors, such as dust, wind, rain, and insects. They are typically mounted to a flange or pipe, which connects the vapor space of a storage tank.

### Product Benefits

- SPVV provides safety . Wire mesh protects your storage tank from out side factors, such as fire, rain, wind, dust, and insects, therefore protects the quality of the liquid.
- Easy to install. You do not need a special tool or experience to install the StorageTech PVV Model 150.
- StorageTech PVV Model 150 comes with the paint color you choose.
- Resistant to corrosion.

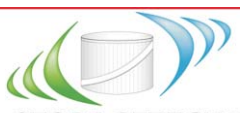

STORAGETECH®

An ERGIL Group Brand

## Manufacturing Materials

---

| Trunk Flange | Cover    | Pressure Direction | Cage Wire |
|--------------|----------|--------------------|-----------|
| Carbon Steel | Aluminum | Carbon Steel       | Aluminum  |
| 304 S.S.     |          | 304 S.S.           |           |
| 316 S.S.     |          | 316 S.S.           |           |

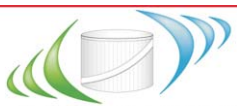

STORAGETECH®

An ERGIL Group Brand

## Dimension and Weights

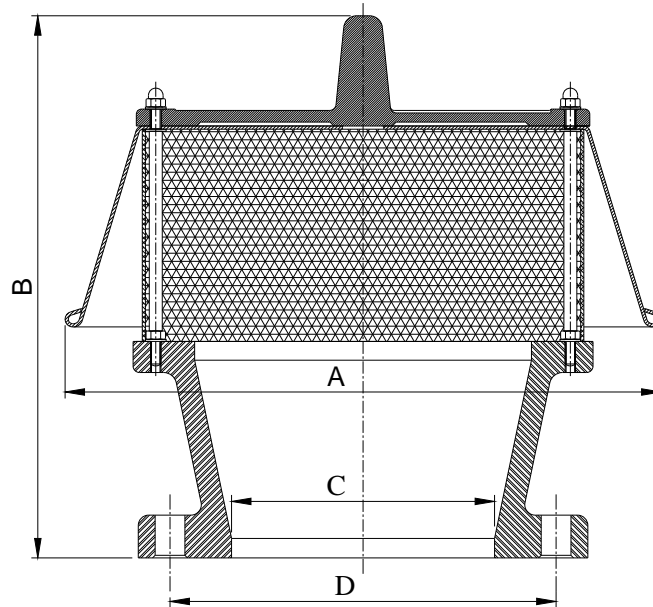

| Model | C<br>Flange Size<br>Inch (mm) | A<br>Width<br>Inch (mm) | B<br>Height<br>Inch (mm) | D<br>LC<br>Inch (mm) | Approx. Wt.<br>Ship.<br>Lb. (Kg) |
|-------|-------------------------------|-------------------------|--------------------------|----------------------|----------------------------------|
| 150   | 2 (50)                        | 9-1/2 (241)             | 7-1/6 (241)              | 4-7/8 (121)          | 16 (7.4)                         |
| 150   | 3 (80)                        | 10-15/16 (278)          | 8-1/7 (276)              | 6 (153)              | 25 (12)                          |
| 150   | 4 (100)                       | 12-1/4 (311)            | 13-2/7 (311)             | 7-1/2 (190)          | 36 (17)                          |
| 150   | 6 (150)                       | 16-1/2 (419)            | 12-4/11 (419)            | 9-1/2 (242)          | 73 (33.1)                        |
| 150   | 8 (200)                       | 20-1/2 (521)            | 16-3/5 (521)             | 11-3/4 (298)         | 102 (46.2)                       |
| 150   | 10 (250)                      | 22-1/2 (572)            | 16-3/5 (572)             | 14-1/4 (362)         | 160 (72)                         |
| 150   | 12 (300)                      | 25-1/8 (686)            | 17-1/6 (686)             | 17 (432)             | 275 (123)                        |

Dimension and Weights